



HEXAGON

2016v01



MARK OUT THE ROOF

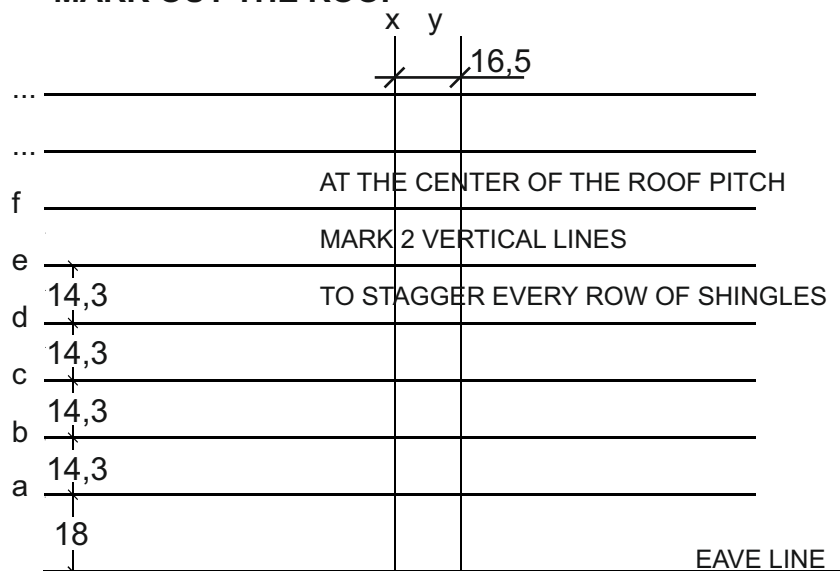

DIMENSIONS

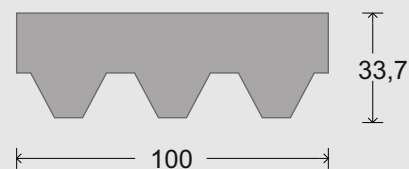

NAIL POSITIONS



60° < PITCH < 85°



INSTALLATION

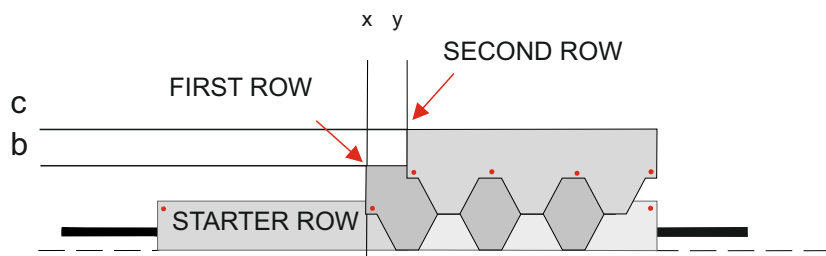
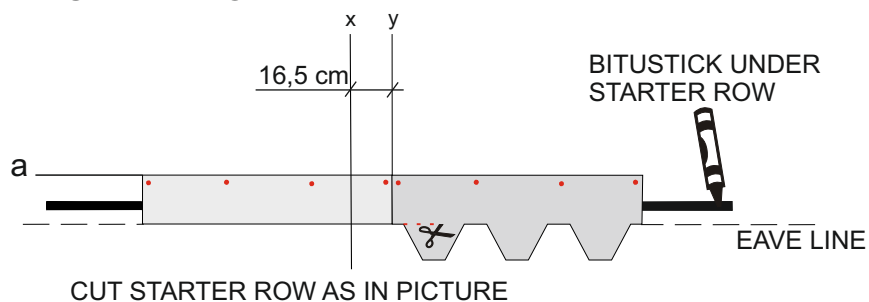

OVERLAP SHINGLES ON EVERY ROW AT 14,3 cm
USE THE VERTICAL LINE TO STAGGER SHINGLE HORIZONTALLY 16,5 cm

REMOVE PROTECTIVE FILM

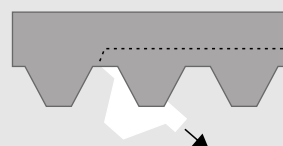

REMOVE THE PROTECTIVE FILM FROM THE BACK SIDE OF THE SHINGLES



HEXAGON

2016v01



HIP AND RIDGE

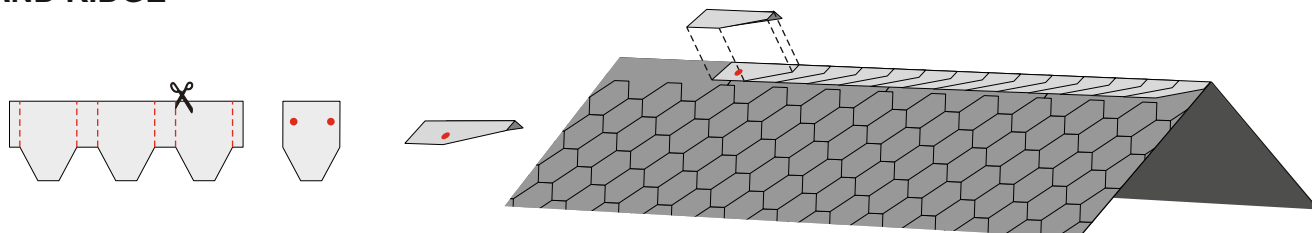

VALLEY TYPE A

- EVERY ROW MUST CROSS THE VALLEY CENTER AT LEAST 25 cm
- ALTERNATE THE OVERLAP OF THE ROW ON THE 2 ROOF PITCHES

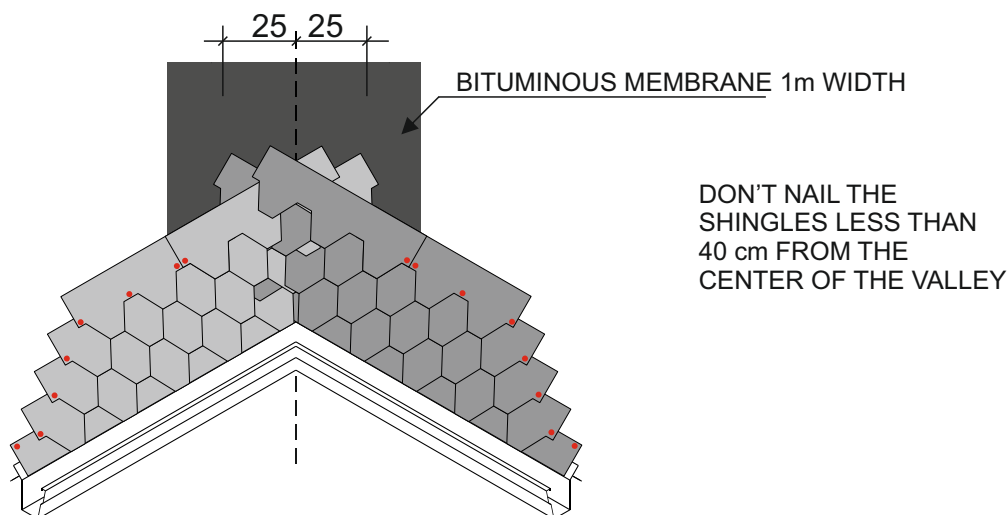

VALLEY TYPE B

- INSTALL THE SHINGLES ON THE FIRST ROOF PITCH AND CROSS THE CENTER OF THE VALLEY AT LEAST 25 cm
- COMPLETE THE SECOND ROOF PITCH AND CUT THE SHINGLES ALONG A LINE AT 5cm FROM THE CENTER OF THE VALLEY

